

## **B44560-1** CHEST MOUNTED DILUTER DEMAND REGULATOR



- **Lightweight**
- **High Reliability**
- **100% Oxygen or Dilution**

---

### ***Application:***

The Chest Mounted Diluter Demand Regulator (CMDDR) can supply 100% oxygen or oxygen diluted with air as selected by the user. The regulator can be used in any environment where user-mounted, lightweight system mobility is required by loadmasters, supplemental oxygen for medical needs, or emergency oxygen.

### ***Features:***

The regulator design is based on the Carleton CRU-103 Chest Mounted Regulator. The CRU-103 is the standard chest mounted regulator for the US Navy, with over 9,000 in service. The CMDDR is a demand regulator with no flow when the mask is off the user's face. The CMDDR has a service ceiling of 35,000 ft (10,668 m) in 100% oxygen mode. The user can easily select between 100% oxygen and dilution (simulating ground level equivalency). The control knob is detented in the selected position thus preventing inadvertent movement. The design heritage, pedigree and commonality with the CRU-103 make this an extremely reliable and easily supported oxygen regulator. The lanyard strap on the regulator provides the user comfort, ease of wearing and quick release during emergency egress.

# SPECIFICATIONS

**CMDDR**  
Part Number: B44560-1

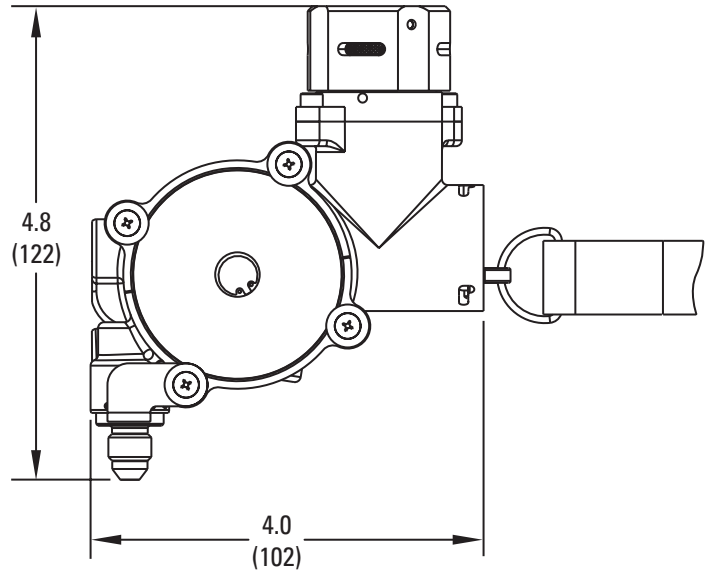
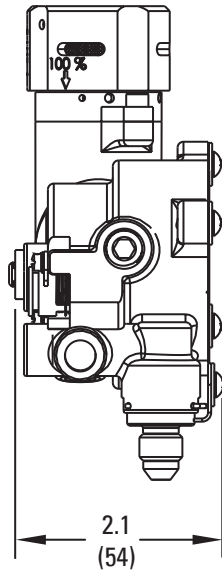

All dimensions in inch (mm)

### Specifications:

<b>Operating Pressure</b>	50 to 70 psig	(3.4 to 4.8 bar)
<b>Flow</b>	0 to 100 slpm	
<b>Operating Altitude</b>		
<b>Ceiling</b>	35,000 ft	(10,668 m)
<b>Air-Oxygen Mixture</b>	32,000 ft	(9,753 m)
<b>100 % Oxygen</b>	35,000 ft	(10,668 m)
<b>Regulator Controls</b>	Normal (diluted) and 100% oxygen	
<b>Weight</b>	16 oz	(0.45 Kg)

### Operating Environment:

<b>Temperature</b>	-40 to 160 deg F	(-40 to 71 deg C)
<b>Humidity</b>	0 to 100%	

### Product Interfaces:

<b>Supply</b>	# 4 AN flared male fitting
<b>Mask</b>	3-pin bayonet to mate with MS27796
<b>Adaptor</b>	Supplied with separate adaptor to accept quick disconnect style mask connection (MS22058-2, Type II)
<b>Mounting</b>	Lanyard Strap